



Instruction Manual

Model : TB-AK01/B

**Hand Dryer
HD/1S**

SAFETY PRECAUTION

IMPORTANT : PLEASE READ BEFORE USING THE APPLIANCES

1. Unplug the power cord during installation, cleaning or relocation of appliances.
2. Do not modify the length of the power cord.
3. Do not use the appliances if the power cord or the plug is damaged, or the power socket is loose.
4. Repairing/servicing of the appliances must be carried out by authorized and qualified electricians only.
5. If the power cord is damaged, it must be replaced by the manufacturer, its service agent or similarly qualified person to avoid a hazard.
6. Do not touch the plug when your hands are wet.
7. It is strictly prohibited to insert foreign objects such as wooden sticks and metal sticks into the air inlet and outlet.
8. When the product is in use, do not place the appliances close to combustible materials such as walls, curtains, etc., which may cause a fire.
9. Place the appliances on a stable and level surface.
10. This appliance is not intended for use by persons (including children) with reduced physical, sensory or mental capabilities, or lack of experience and knowledge, unless they have been given supervision or instruction concerning use of the appliance by a person responsible for their safety. Children should be supervised to ensure that they do not play with the appliance.
11. When the appliance is used in a bathroom, unplug it after use since the proximity of water presents a hazard even when the appliances is switched off.
12. For additional protection, the installation of a residual current device (RCD) having a related residual operating current not exceeding 30mA is advisable in the electrical circuit supplying the bathroom. Ask your installer for advice.
13. In order to avoid a hazard due to inadvertent resetting of the thermal cut-out, this appliance must not be supplied through an external switching device, such as a timer, or connected to a circuit that is regularly switched on and off by the utility.
14. This appliance is designed to use only those parts supplied with this appliance and/or accessories designated specifically for use with this appliance. Using parts and/or accessories not designated for use with this appliance could result in personal injury or property damage.

PARTS & ACCESSORIES

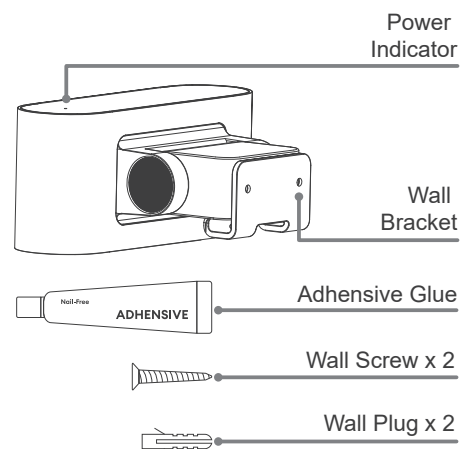
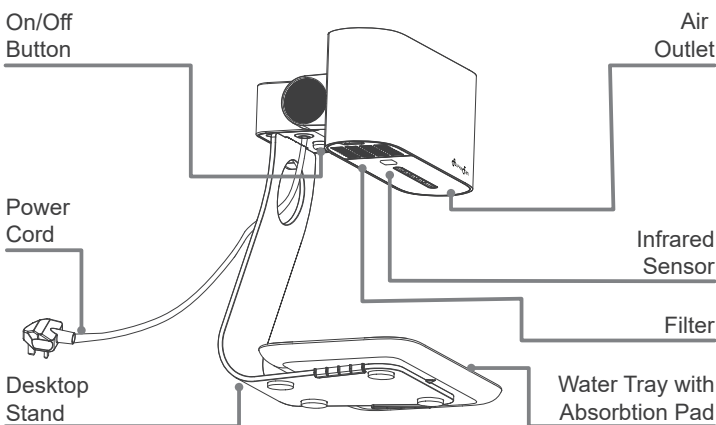

Desktop Installation

Note: Water Tray must be installed together with Desktop Stand to ensure normal operation.

STEP 1

1. Put Water Tray on top of Desktop Stand as per figure shown. Ensure convex point at back side of Water Tray is facing downwards.
2. Slide the Water Tray downwards until snug.

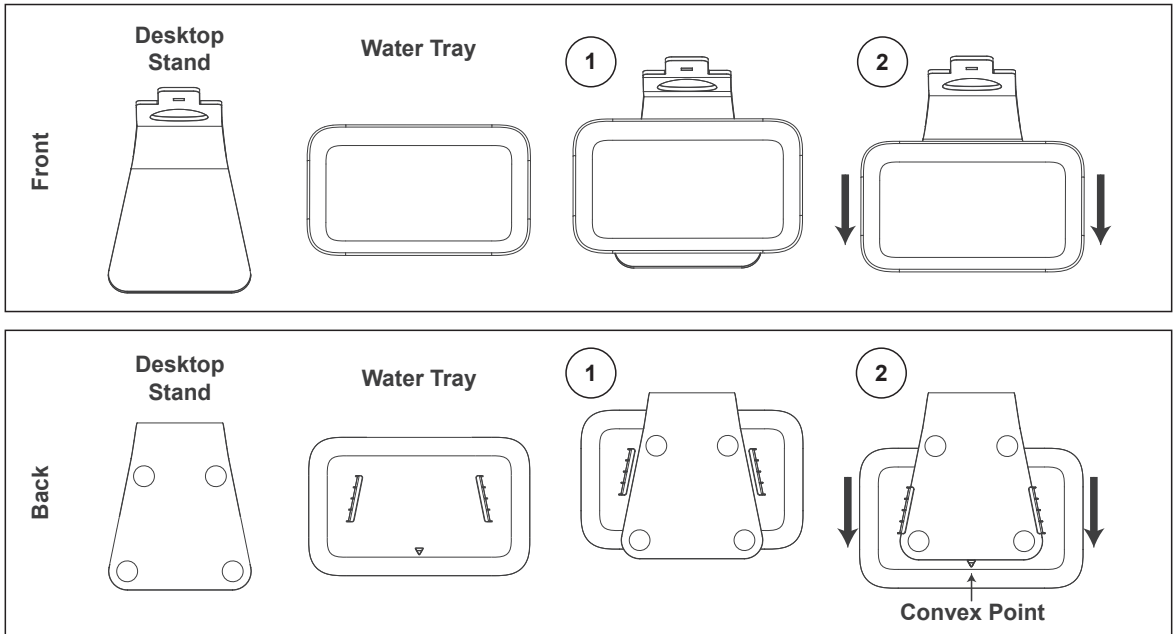

STEP 2

1. Align the mounting hole on Hand Dryer body with Desktop Stand.
2. Push down until Hand Dryer is fixed on the Desktop Stand.

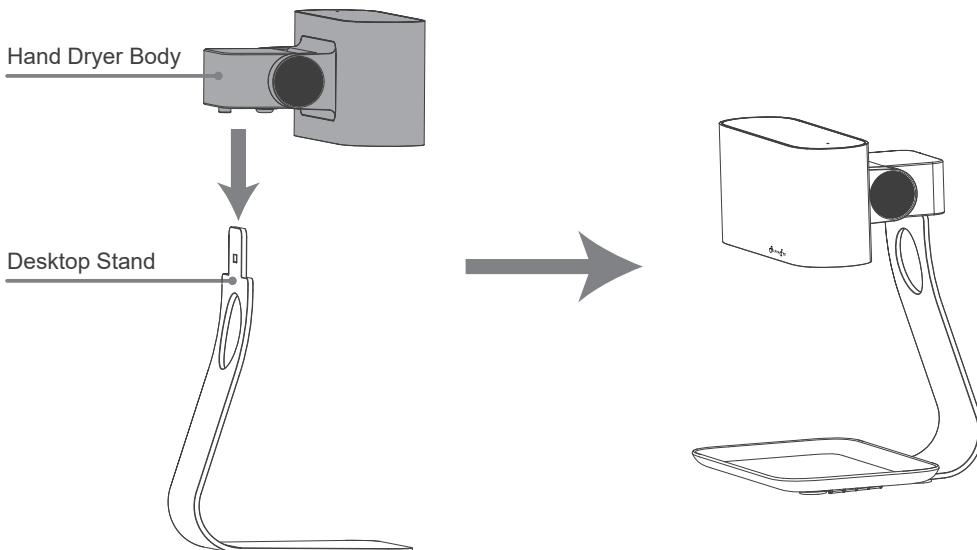

Wall Mount Installation

IMPORTANT

- Hand Dryer **SHOULD NOT** install inside zone 0, 1 and 2.
- Ensure installation distance meet the requirement as per figure below.

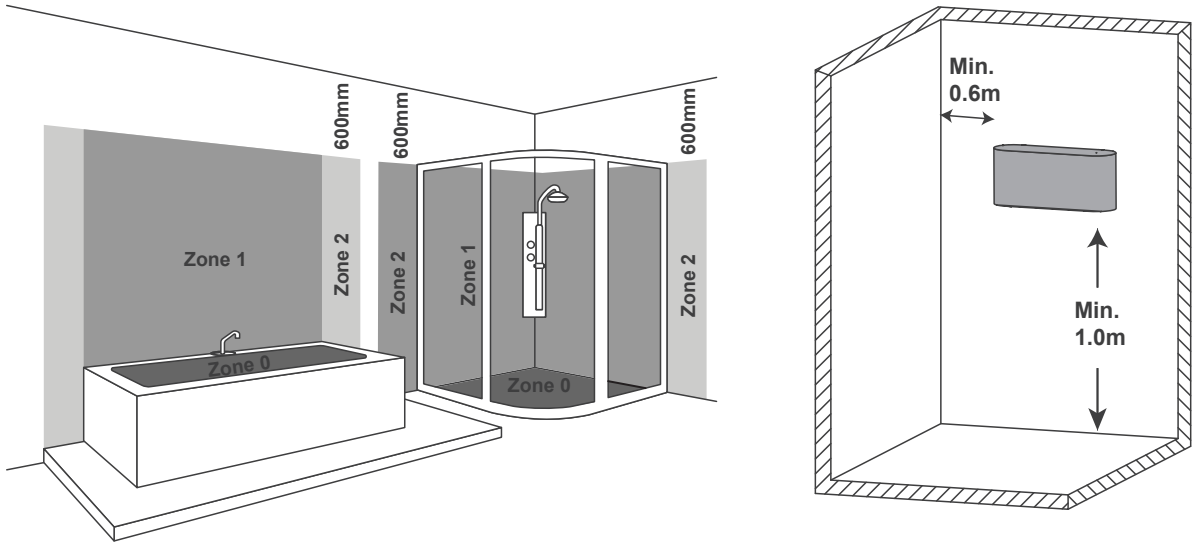

STEP 1

1. Drill two holes on the wall with diameter of 5mm and depth of 35mm. The distance between two holes is 53.4mm.
2. Insert Wall Plug into the two holes. Then secure the Wall Bracket to the wall using screw provided.
3. Ensure screw is tighten and firm.

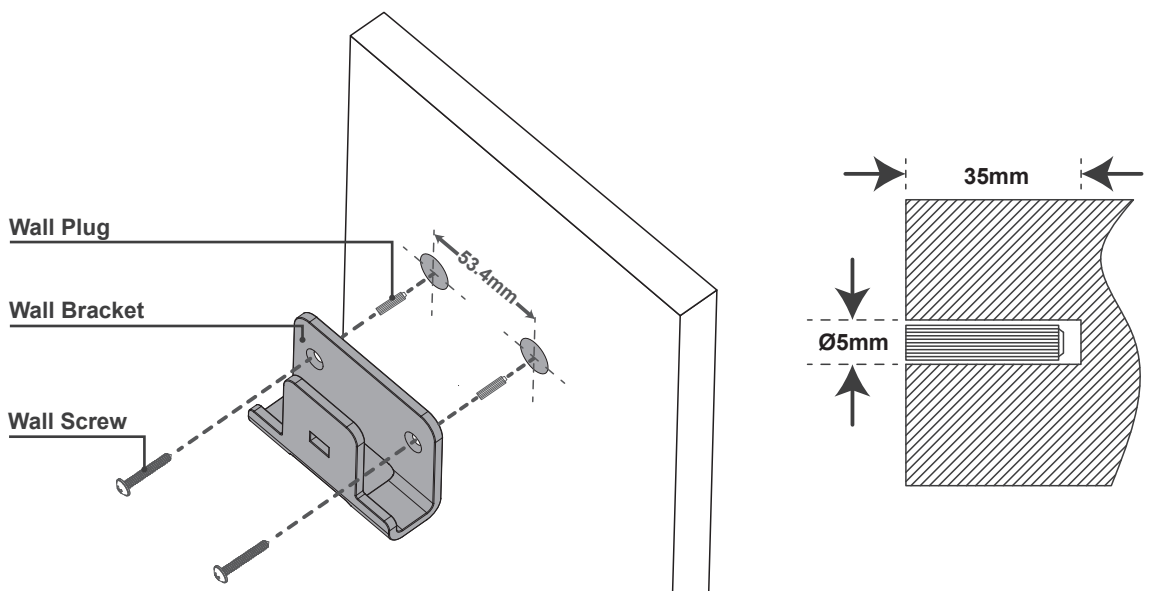

STEP 2

1. Attach the Hand Dryer to the Wall Bracket, align mounting hole on Hand Dryer body with Wall Bracket.
2. Push down until Hand Dryer is fix on Wall Bracket.

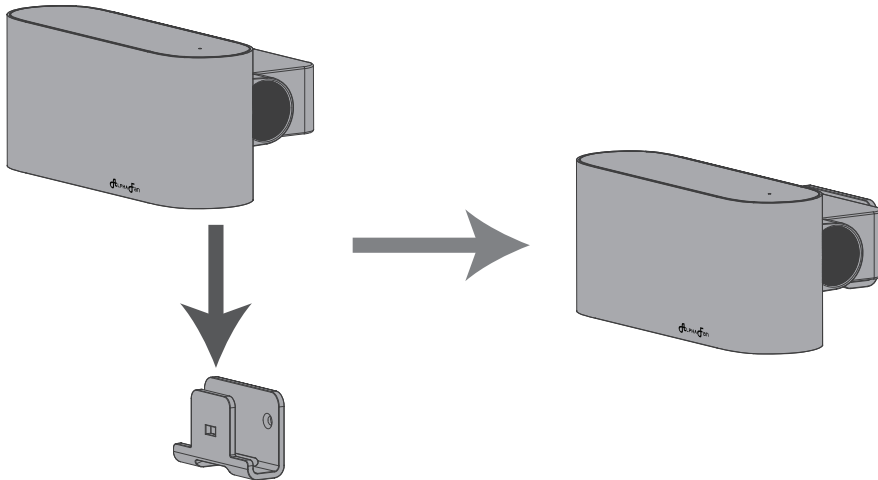

FUNCTION AND FEATURES

1. Turn on power at mains supply, press On/Off button located at bottom of Hand Dryer as per figure below.
2. If Hand Dryer is powered and enter standby mode, power indicator will light up.
3. Hand Dryer will automatically activate when hand is detected at air outlet (approximate 8cm).
4. If hand is removed from air outlet, Hand Dryer will automatically stop after 3 seconds and enter standby mode.
5. The dry hand function will continuously operate not more than one minute, it will automatically stop and enter standby mode after 1 minute.
6. After stopping, remove your hand from air outlet and if you put hand to air outlet again, the dry hand function will operate again.
7. To remove the Hand Dryer from the Desktop Stand or Wall Bracket.
 - i. Press the Hand Dryer Dismantle Button, as per figure 2 below.
 - ii. Lift up the Hand Dryer from the Desktop Stand or Wall Bracket.

Figure 1

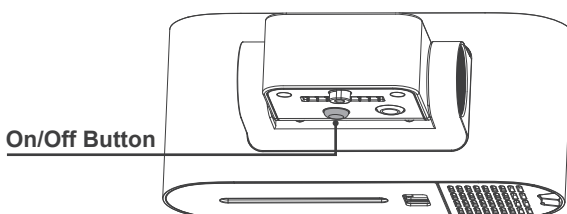
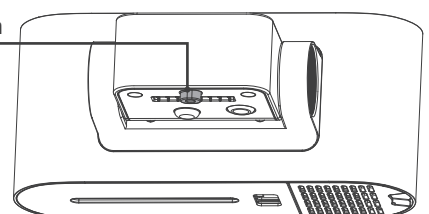

Figure 2

Hand Dryer
Remove Button



IMPORTANT : BEFORE PERFORMING ANY MAINTENANCE WORK, UNPLUG THE HAND DRYER FROM THE SUPPLY SOCKET.

1. For body surface cleaning, use a wet cloth (or add a little detergent) to wipe. Do not use petrol, asphalt, diluent corrosive detergent or solvent for cleaning, it is strictly prohibited water rinse wash.
2. Advise clean the Water Tray and Absorption Pad once per week.
3. If too much foreign matter adheres to the dust net, it will affect the noise and airflow effect, so it should be cleaned at least once every month.
4. Follow below instruction for Dust Cover cleaning procedure:
 - i. Remove Dust Cover from Hand Dryer.
 - ii. Remove filter from Dust Cover, soaked with cleaning agent for few minutes then clean and let it air-dry.
 - iii. Install filter and Dust Cover back to Hand Dryer. Ensure Dust Cover is completely dry before installation.

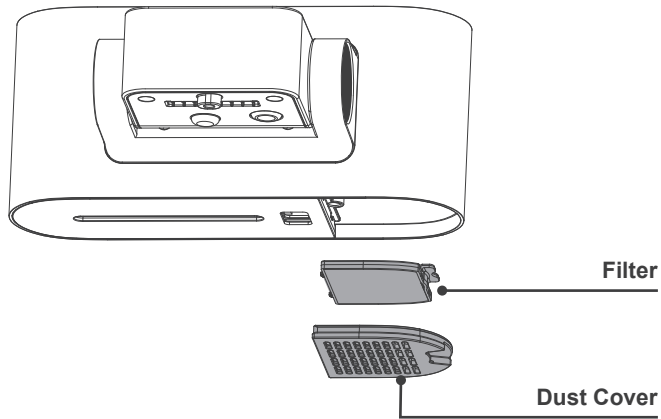

TECHNICAL SPECIFICATIONS

| | |
|-------------------------|---------------------|
| Model | TB-AK01/B |
| Rated Voltage Frequency | 220-240V / 50-60Hz |
| Rated Power | 700W |
| Noise | <70dB |
| Dimension | 214 x 187 x 266.9mm |
| Nett Weight | 1.3kg |

If you need any technical assistance or faulty report, please contact our customer service centre at :

Malaysia

Alpha Home Appliances Sdn. Bhd. (390258-H)

Head Office : 6, Jalan Sungai Kayu 32/37, Berjaya Park, Sect 32,40460 Shah Alam, Selangor.

Tel : 03-5740 6666 Fax : 03-5740 8220

Website : www.alphamalaysia.com Email : info@alphamalaysia.com

Johor : 71, Jalan Molek 3/10, Taman Molek, 81100 Johor Bahru.

Tel : 07-353 4833 / 4933 Fax : 07-355 4233

Melaka : 19, 19-1 & 19-2, Jalan KSB 11, Taman Kota Syahbandar, 75200 Melaka.

Tel : 06-292 2398 / 2399 Fax : 06-292 2392

Perak : 11, Jalan Tasek Timur 5, Taman Tasek Indra, 31400 Ipoh, Perak.

Tel : 05-545 2282 / 547 2282 Fax : 05-547 6282

Penang : 28 Jalan Icon City, Icon City, 14000 Bukit Mertajam, Pulau Pinang.

Tel : 04-506 2366 / 2066 / 2566 Fax : 04-506 2966

Pahang : A131, Jalan Dato Wong Ah Jang, Taman Liza, 25100 Kuantan, Pahang.

Tel : 09-516 5226 Fax : 09-513 9226

Singapore

Alpha Sales & Services Pte. Ltd. (200709461 R)

50, Ubi Avenue 3, #02-16/17, Frontier, Singapore 408866.

Tel : +65 6841 0111 Fax : +65 6747 0030

Website : www.alphasingapore.com Email : customercare@alphasingapore.com